

Please Note

Please follow all instructions carefully. Failure to do so could invalidate your guarantee. As with the installation of any water bearing product, you must make sure that any laws prevalent to your area are followed. Such laws may include Local & National Water Supply Authority Regulations or Byelaws and Building and Plumbing Regulations. We recommend that a qualified registered plumber is used to install your product. Please ensure that when fitted, the product is easily accessed for service and maintenance requirements. Armera cannot be held liable for costs associated with accessing the product after it is fitted.

Contact Us

Should you need any assistance, please e-mail us at info@armera.co.uk or call 01225 251 204.

Caring for your Armera product

We recommend only cleaning your product with a soft damp cloth. Please do not use any other cleaning products as they may damage the high quality finish of this product.

Guarantee

This Armera product is guaranteed against manufacturing defects. The cover period is from date of supply to the Armera customer and will last for 2 years for parts and labour. The parts guarantee can be extended to 15 years by registering your guarantee. To register your guarantee and review all guarantee conditions, please go to www.armera.co.uk



ARMERA®

Installation Instructions

BW.233 Bath filler waste with twist handle plug operation



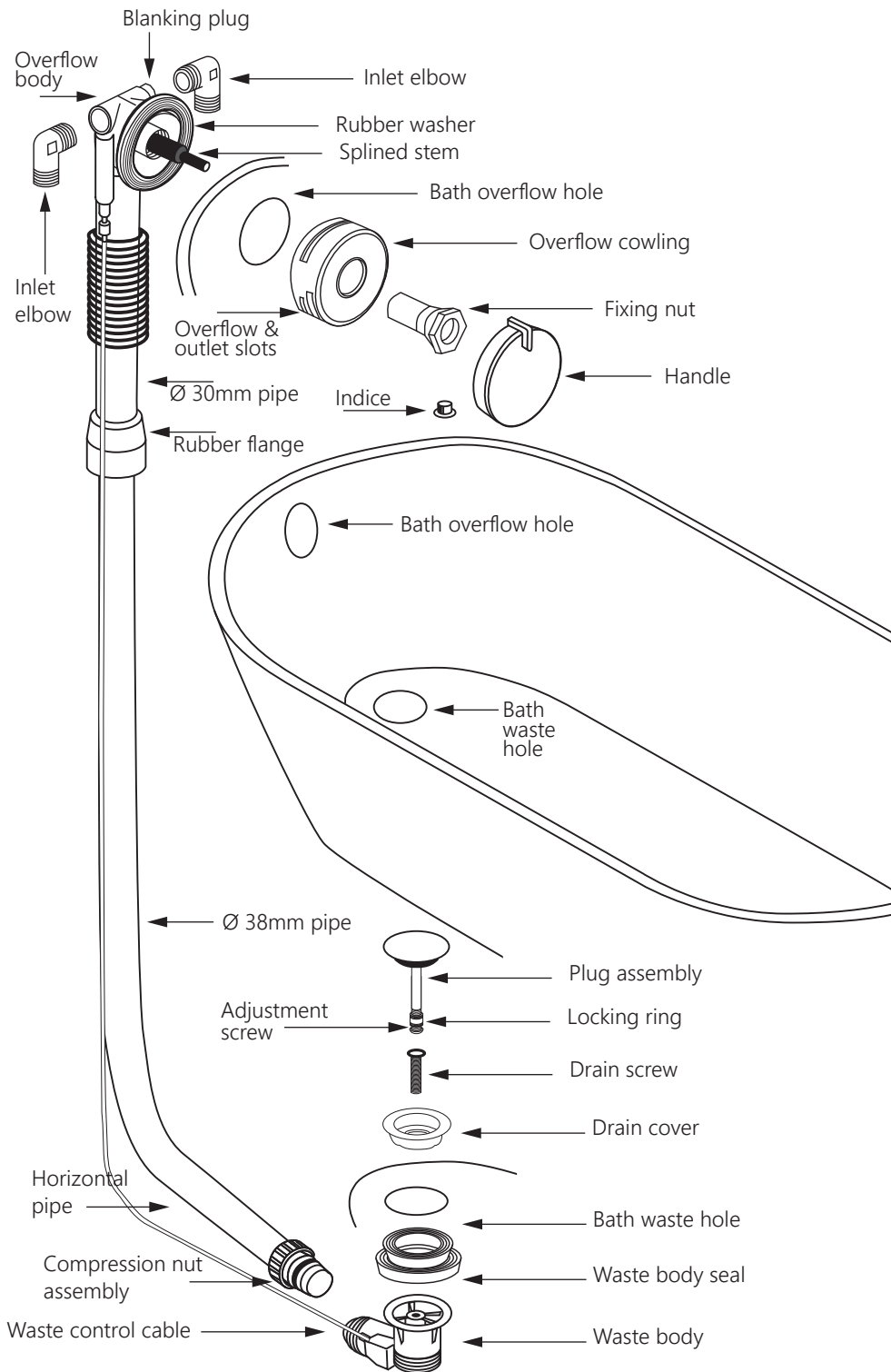

Installation

1. If using blended water supply to the filler waste, leave the blanking plug in position in one inlet. Using PTFE tape, fit an inlet elbow to the other inlet.
2. If using separate hot and cold supplies, remove the blanking plug from the overflow body and using PTFE tape, fit both inlet elbows into the overflow body.
3. Unscrew the fixing nut from the overflow body and remove the overflow cowling.
4. From the rear of the bath, position the splined stem into the overflow hole on the bath and re-attach the overflow cowling on the front of the bath ensuring that the overflow and outlet slots face downwards.
5. Attach the handle onto the splined stem (ensuring grub screw hole is at the bottom) and secure in position by tightening the grub screw.
6. Insert the indice into the grub screw hole.
7. Connect the water supply to the inlet elbow(s).
8. Remove the plug assembly from the waste body and unscrew the drain screw to remove the drain cover. Keep all of these parts safely aside for use later.
9. Join the Ø30mm pipe to the Ø38mm pipe using the rubber flange. The length of the upright pipe can now be altered by sliding the Ø30mm pipe up or down inside the Ø38mm pipe. If necessary, either of the pipes can be cut down to further reduce the length.
10. Cut the horizontal pipe to desired length so that the waste body sits directly under the waste hole in the bath when it is attached to the pipe.
11. Join the horizontal pipe to the waste body using the compression nut assembly.
12. Push the top part of the waste body seal up through the waste hole in the bath.
13. Position the drain cover on top of the waste hole in the bath and re-attach it to the waste body using the drain screw.
14. Insert the plug assembly into the drain cover. If necessary, the length of the plug stem can be adjusted using the adjustment screw. Lock the adjustment screw into position using the locking ring.
15. Check for leaks.

Operation



Twist handle clockwise to open plug

Twist handle anti clockwise to close plug